



QA CHECKLIST	
Fabricator	
Date Issued	
Time Start	
Time finish	
Preweld Check	
Final Check	

ASSEMBLY	GRID LOCATION
T/104	D-E/5-3

- GENERAL NOTES
- HOLES 22 DIA. FOR 8.8S BOLTS UNLESS NOTED.
  - ALL WELDS TO BE 6 CFW, E48XX UNLESS NOTED OTHERWISE.
  - ALL BUTT WELDS TO BE FULL PENETRATION UNLESS NOTED.
  - ALL NOTCHES TO HAVE 10mm RADIUS AT INTERNAL CORNERS.
  - ASSEMBLY MARK TO BE STAMPED ON TOP FACE WHERE INDICATED THUS 
  - THIS SYMBOL  INDICATES CONNECTING FACE OF CLEAT.

SUB-ASSEMBLY REF.	
No.	In Assembly.
1	ALONE

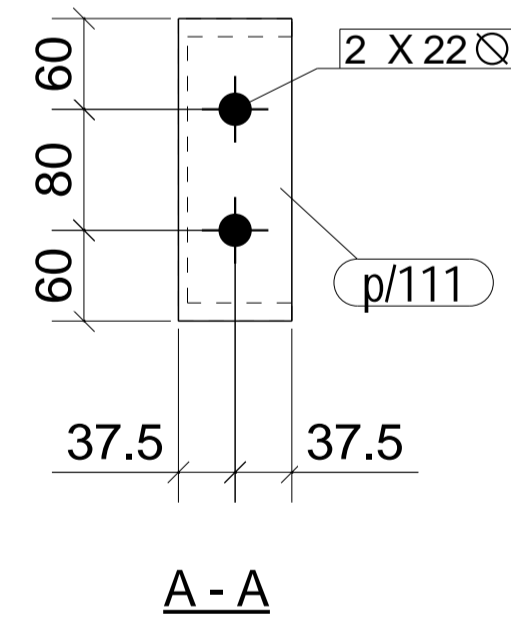
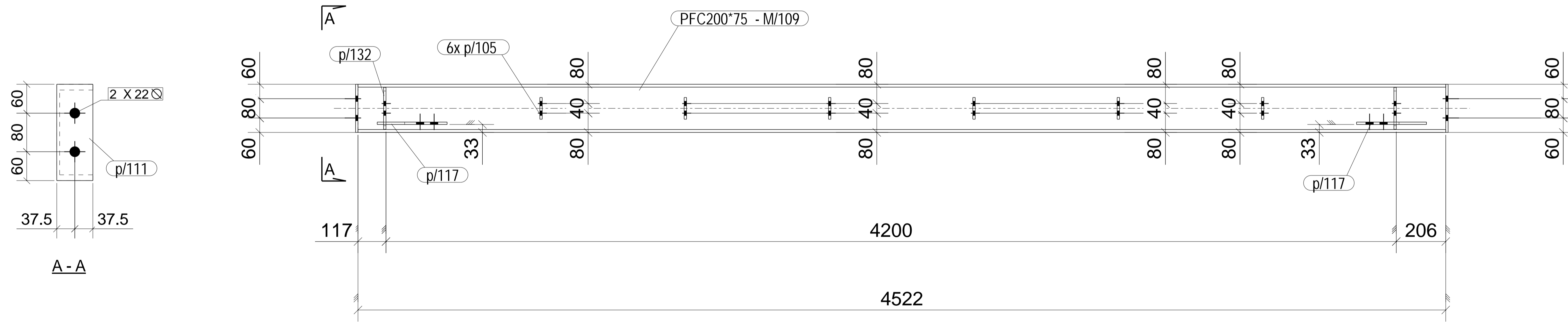
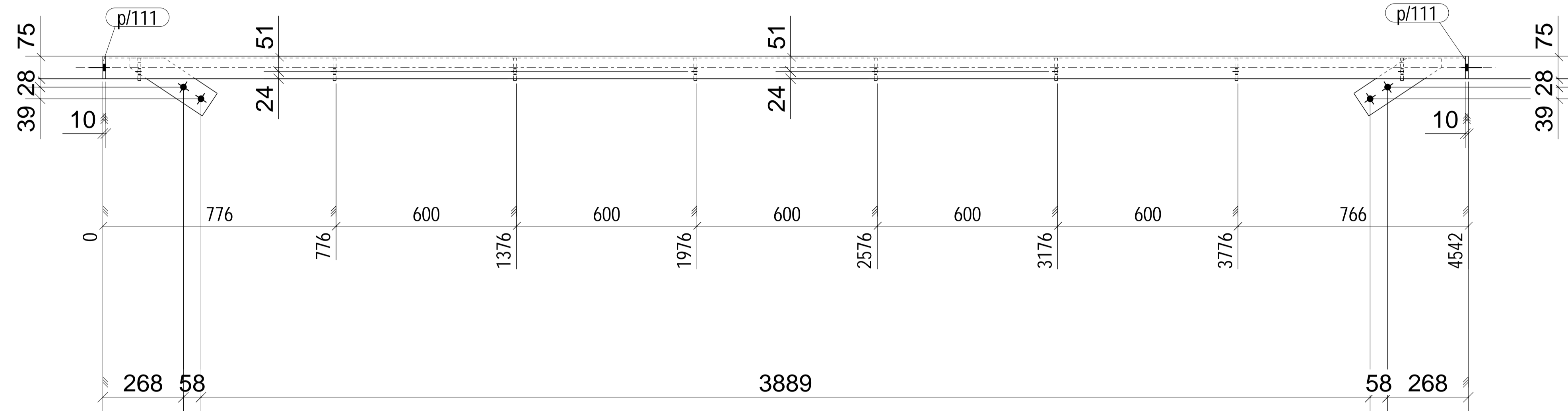

MATERIAL LIST						
ITEM	No.OFF	SECTION	LENGTH	GRADE	WEIGHT(kg)	AREA(m <sup>2</sup> )
M/109	1	PFC200*75	4522	300	103.7	3.1
p/105	6	FL10*75	90	250	3.2	0.1
p/111	2	FL10*75	200	250	2.4	0.1
p/117	2	FL10*90	307	250	3.8	0.1
p/131	1	FL10*75	174	250	1.0	0.0
p/132	1	FL10*75	174	250	1.0	0.0
TOTAL					114.9	3.4

PHASE	QTY.
1	1

**1 PFC[S] REQ'D AS DRAWN MK T/104  
Finish - HOT DIP GALVANISED**

REV	DATE	DESCRIPTION
0	19.05.2015	For Construction

DRAWING TITLE		PFC new	
CONTRACT		Chiller platform	
MODELLED BY	B.A.	ISSUE DATE	23.05.2016
JOB NUMBER	245151	DRAWING No	
SCALE	1:5	T/104	

